

# APOLLO EURO TOURER

## 2 berth motorhome

Features include heated/air-conditioned cabin and living area, shower and toilet, large double bed and fully equipped kitchen including microwave, gas stove and refrigerator. Ample storage space and a powerful and reliable 2.2 Litre turbo diesel engine complete the perfect touring vehicle for couples.



### What's included with the Apollo Euro Tourer

- Cooking equipment
- Personal kit (Including bedding and towels)
- Camping chairs and table
- Toilet chemicals (Initial Set)
- Unlimited kilometres
- Extra driver fees
- Excess liability reduced to AUD250
- Full gas canister (LPG)
- Snow chains (on request)
- Baby booster seat (on request)



## Vehicle Specifications

- Mercedes or Similar
- Cruise Control
- 12V battery / 240V mains power / Solar Panel
- Automatic transmission
- Diesel Engine
- Fuel capacity: 71L

## Features

- 2 Seatbelts in Driver Cab
- Pressurised Hot & cold water
- Shower
- Toilet
- 75L freshwater tank
- 55L wastewater tank
- Kitchen Sink
- Fridge/Freezer 78L
- Microwave - operates when connected to 240V mains power
- Gas Cooker
- Gas Bottle
- Air conditioning Drivers Cab /Main Cab (240V)
- Heating Drivers Cab / Main Cab (240v)
- Driver & passenger airbags in driver's cabin
- Internal walk through access
- Multimedia Touch Screen
- Unit with Bluetooth
- Android Auto and Apple CarPlay
- CD player
- MP4,MP3 and USB,
- Fire extinguisher
- Central locking for the driver's cab
- Reversing camera
- front swivel seats

## Sleeping for up to 2 Adults

- Rear - Double Bed 1.9m x 1.7m

## Vehicle Dimensions

- Length – 7.05m
- Width – 1.93m
- Height – 3.10m
- Interior Height – 1.92m



## Apollo Euro Tourer Floorplans

Day



Night

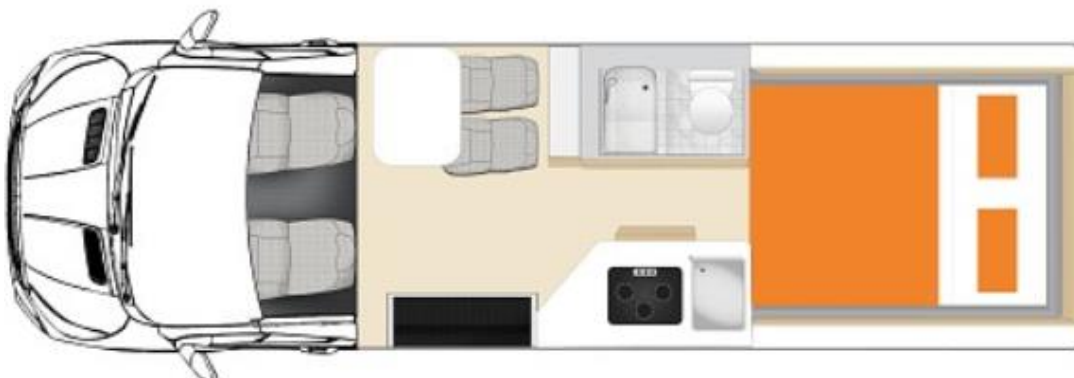

Floor plans and specifications are intended as a guide and Apollo cannot guarantee exact specifications and layouts.

Available on all independent and tailor-made holidays in Australia.