

# LET'S GO CRUISER

## 3 berth motorhome

Luxury and comfort for three, the Let's Go Cruiser is the perfect home away from home for a small family. The self-contained motorhome offers a comfortable living space for two adults and a child, with large panoramic windows for cross ventilation and stellar views



### What's included with the Let's Go Cruiser

- Kitchen equipment
- Linen and bedding (including pillows, pillowcases, duvet, sheet and towels)
- Unlimited kilometers
- Extra driver fees
- GPS
- Toll Pass
- Excess liability reduced to zero
- Windscreen and tyre protection
- Single vehicle rollover cover
- Full gas canister (LPG)
- Child seats (if required)
- Picnic table and chairs (1 chair per person travelling)



## Vehicle Specifications

- Vehicle make: Renault
- Engine: 2.3L Diesel
- Automated Manual
- Power steering
- Reversing camera
- Air-conditioning
- Heating: Drivers Cab + Main Cab
- Fuel tank capacity: 100L
- Fresh water tank: 65L
- Grey water tank: 45L
- 3 seatbelts in the driver's cab
- Power supply: 240v mains/12v battery/solar
- Fire extinguisher
- Fridge/freezer: 85L
- Microwave
- Sink
- 2 Burner stove
- Awning
- Cutlery & cooking utensils
- Crockery and glasses
- Pots and pans
- Kettle and toaster
- Pressurised water
- Radio and CD player
- DVD player with TV
- Toilet
- Shower

## Sleeping for up to 2 Adults & 1 Child

- Queen Bed (Dinette) 1.54m x 2.09m
- Single Bed (Over-cab) 1.11m x 1.90m

## Vehicle Dimensions

- Length – 6.25m
- Width – 2.31m
- Height – 3.20m
- Interior Height – 2.00m



## Let's Go Cruiser Floorplans

Day

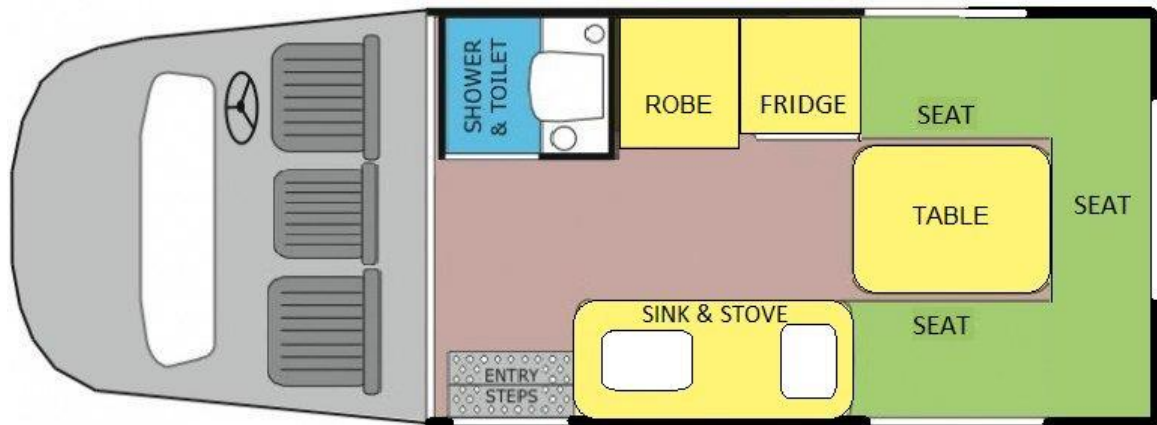

Night

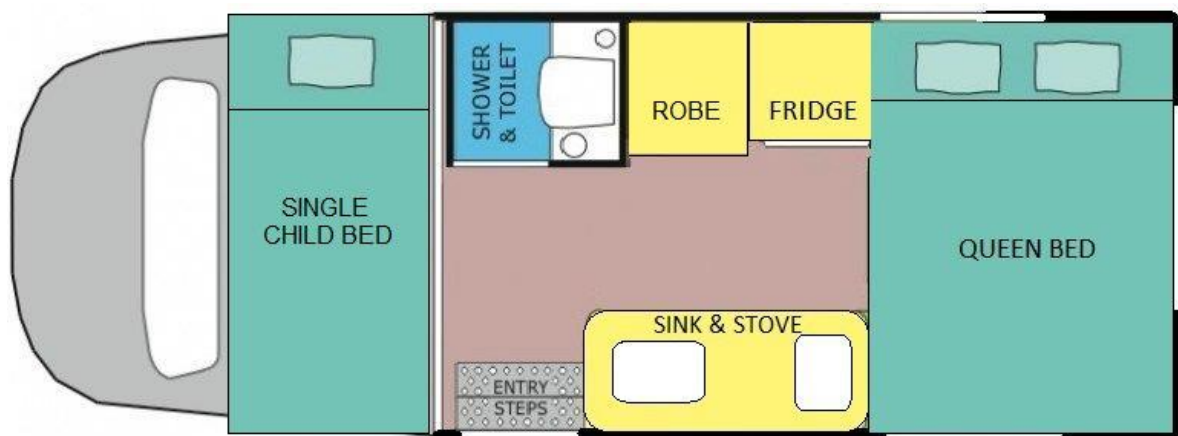

Floor plans and specifications are intended as a guide and Let's Go cannot guarantee exact specifications and layouts.

Available on all independent and tailor-made holidays in Australia.